

# iOS – User Setup Guide for iOS Mail App

## Disclaimer

These instructions were created with the expectation that the device is a current model running the most recent operating system. If this is not the case, your experience may vary.

## Before You Begin

**iOS REQUIREMENTS:** Only the two most recent OS versions are supported.

**PREREQUISITES – Prior to configuring the iOS native mail app on your iOS device:**

- Complete your registration at [id.delaware.gov](http://id.delaware.gov) and enrollment of MDM (Microsoft Intune Company Portal app).
- Remove State email accounts from your mobile device's native mail app.\*

## iOS Mail App Setup

**\*NOTE: Even users using their iPhone's native mail app already will need to follow these instructions and set up a new Exchange Online account.**

1. Go to your iPhone or iPad's **Settings** > scroll down and tap **Passwords & Accounts** > **Add Account**

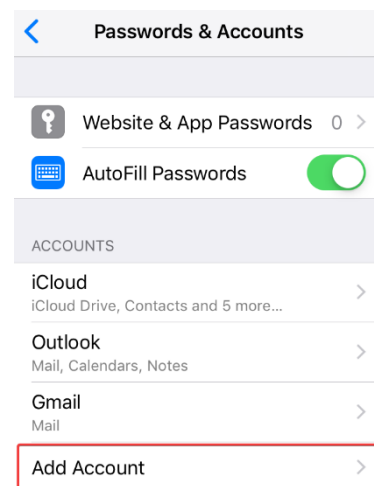
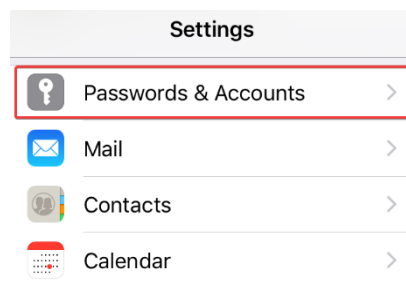

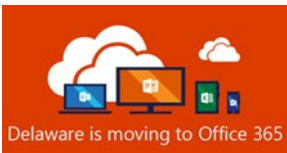

2. Select **Exchange**

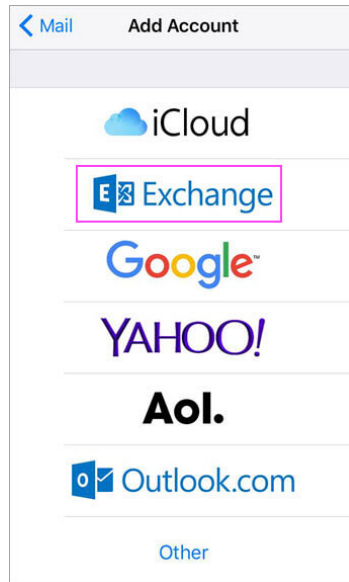

3. Enter your State email address and a description of your account. Tap **Next**.

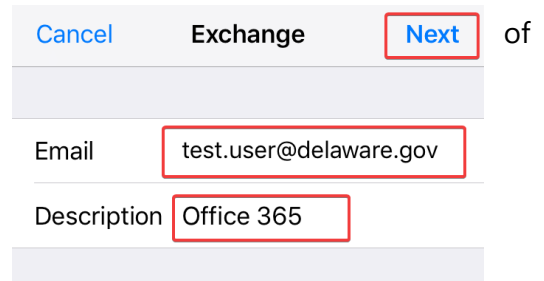

4. Tap **Sign In**.

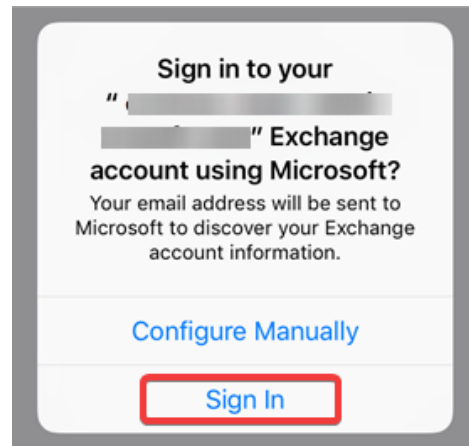

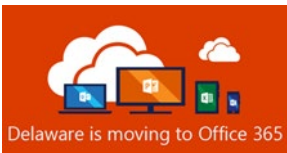

- 5. Enter your Windows Domain password and tap **Sign In**.

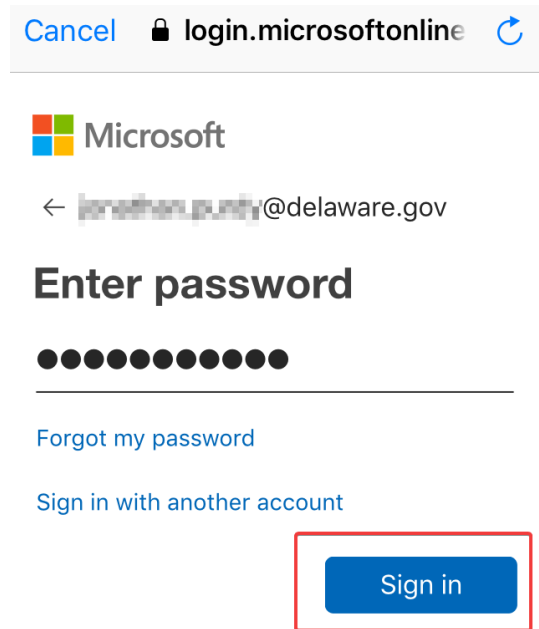

- 6. Approve the multi-factor authentication request.



- 7. Tap **Continue** on the client certificate prompt.

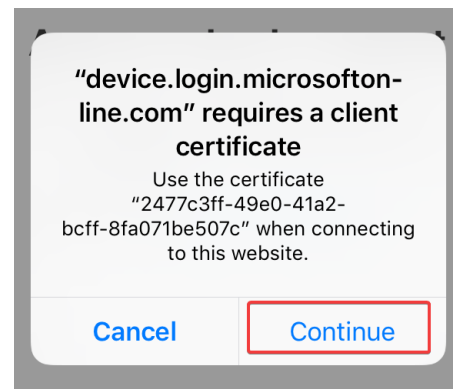

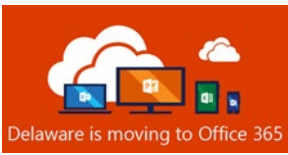

8. Choose the services you want to sync with your iOS device and tap **Save**. You're done!

